

## MANUAL ANGLE SEAT VALVE 1/2 ÷ 2; BRONZE

flow over / under seat

TYPE: CMN

### TECHNICAL SPECIFICATIONS

Media: water, oil, air, aggressive media and steam <sup>(1)</sup>

Media temperature: 14°F ÷ 356°F

Ambient temperature: 14°F ÷ 140°F

Body material: bronze (C38600 UNS Designation)

Bonnet material: brass (C37700 UNS Designation)

Seal material: PTFE

### OPTIONS

GAS connection (ex. code CMG2050TW00)



SELECTION TABLE	VALVES	pipe size	orifice	Flow rate	OPD working pressure <sup>(1)</sup>		flow direction
	Code	(NPT)	(inch)	(gpm)	min (psi)	max (psi)	
	CMN2050TW00	1/2	5/8	6.8	0	362	1 ↔ 2
CMN2060TX00	3/4	3/4	11	0	362	1 ↔ 2	
CMN2070TY00	1	1	18	0	362	1 ↔ 2	
CMN2080TZ00	1 1/4	1 1/4	28	0	362	1 ↔ 2	
CMN2090TK00	1 1/2	1 1/2	49	0	362	1 ↔ 2	
CMN2100TJ00	2	2	66	0	232	1 ↔ 2	

(1) Steam: Max. working pressure 145 psi (9 barg);

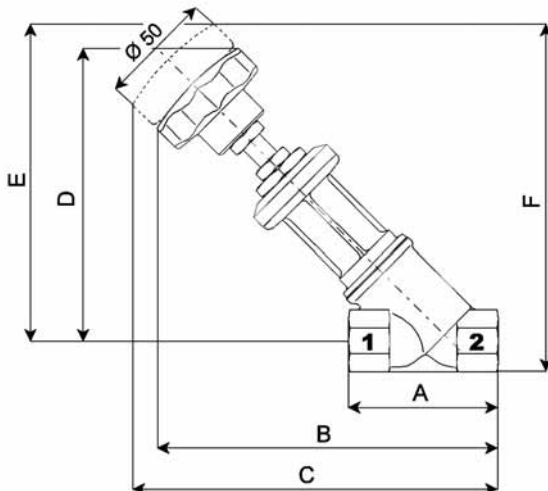

### DIMENSIONS & WEIGHTS

pipe size	A	B	C	D	E	F	weight
(NPT)	(inch)	(inch)	(inch)	(inch)	(inch)	(inch)	(kg)
1/2	2.56	5.59	5.90	4.76	5.03	5.59	1.65
3/4	2.95	5.82	6.10	4.96	5.23	5.90	1.76
1	3.54	6.41	6.77	5.31	5.70	6.49	2.64
1 1/4	4.33	6.88	7.40	5.62	6.14	7.12	3.69
1 1/2	4.72	7.08	7.59	5.82	6.33	7.44	4.63
2	5.91	7.99	8.34	6.18	6.69	8.07	6.83